

SIRCO M and **MV** Modular universal switches from 16 to 160 A

THE VERSATILE SOLUTION



SOCOMEK : Innovators in LV switching solutions

As a world leader in electrical switching and protection systems, SOCOMEC launches a new generation of load break and changeover switches for applications from 16 to 160 A.

SIRCO M and **MV** : Total integration of all electrical functions: isolating, control and changeover switching

SOCOMEK has developed a new technical concept that combines the features of a load break switch and a changeover switch in order to propose a highly innovative modular design.

SIRCO M and **MV** : Full compliance with IEC, EN 60947-3 or UL 508 standards

The new **SIRCO M** and **MV** range of load break switches has been designed, qualified and tested according to the criteria defined by the IEC 60947-3 standard.

This process guarantees a high quality level for the product which is fully adapted to arduous operating environments when operating in the field.

ADDITIONAL SOCOMEK SWITCHING SOLUTIONS

> **SIRCO** load break switches up to 5000 A

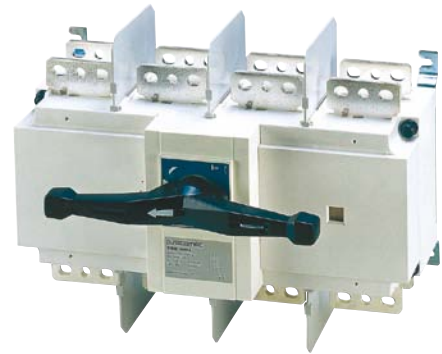

SIRCO 353 A

> Manual and motorised changeover switch



ATY3M 007 A

> Fuse combination switches **FUSERBLOC** - Front or right side operation

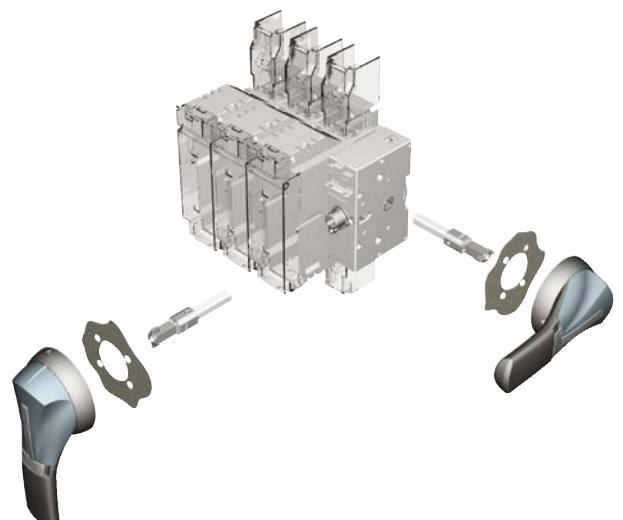

FUSER 703 A



ATY3 079 A

SIRCO M Modular universal switches the versatile solution

Use standard components to create a solution that perfectly suits to your application.

SWITCHING & DISCONNECTION

For safe and optimised operation of LV electrical circuits.

CHANGEOVER SWITCHING

Two mechanically interlocked switches.

ADAPTABLE

To all motor or distribution load applications.

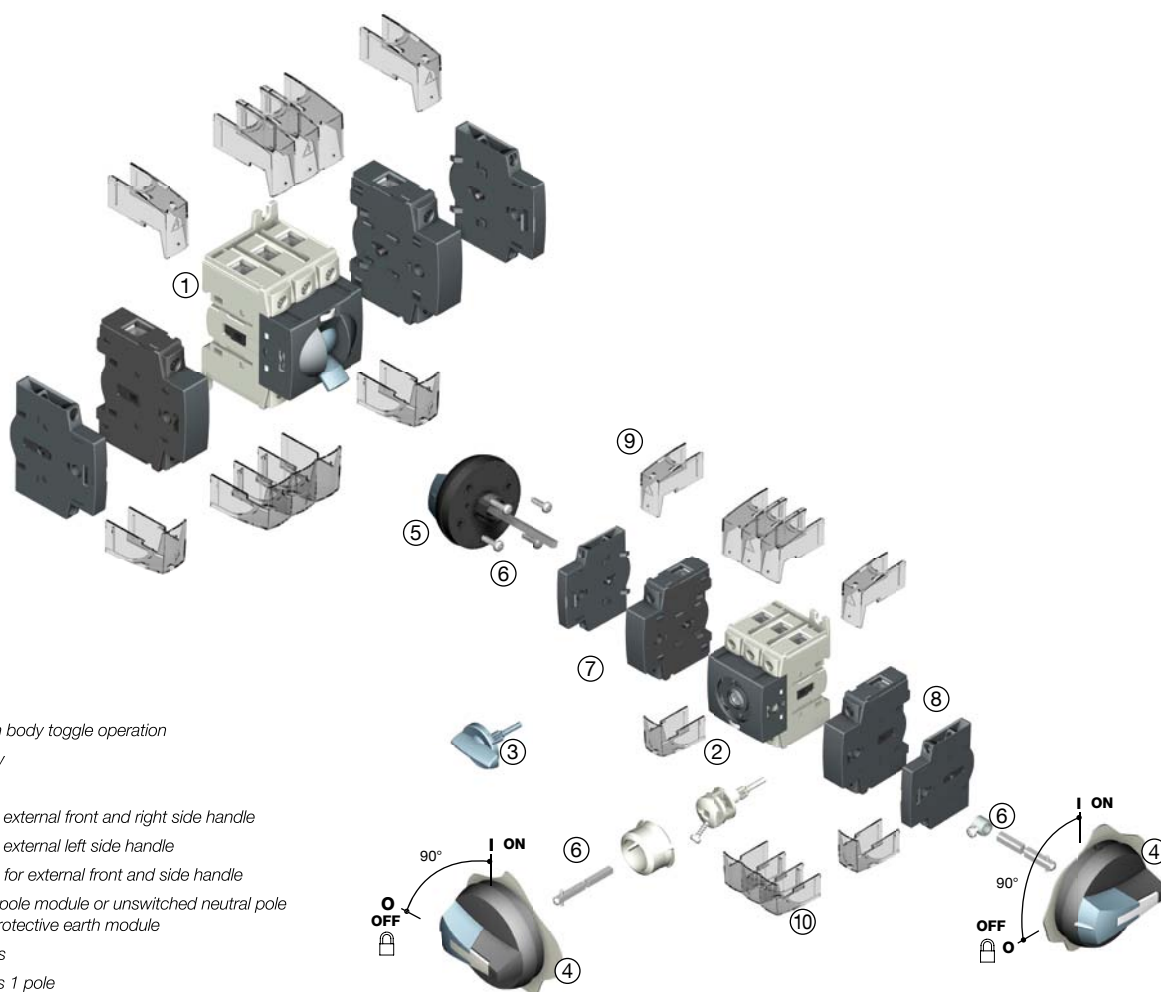

COMPLETE INTEGRATION WITHIN ALL OF YOUR INSTALLATIONS

- > Distribution panel - Incoming or feeder
- > Panel mounted or DIN modular
- > Machine control
- > Local safety break

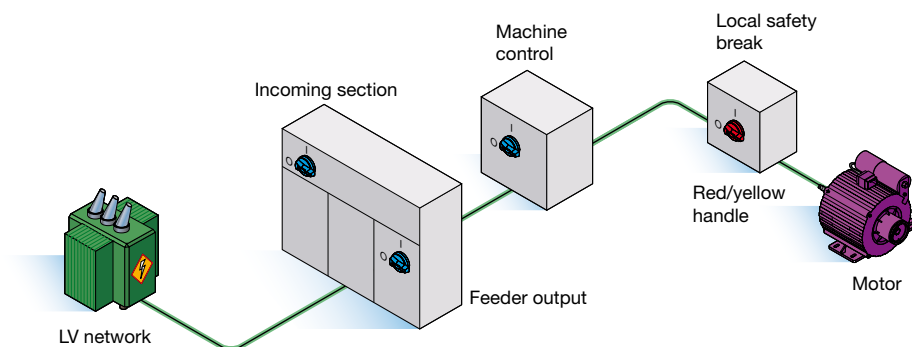

AN OPTIMISED BREAKING SYSTEM

> SIRCO M

Contact point technology and front or side operation.



SIRCO 163 A - 164 A

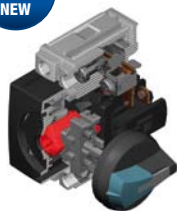

Position 0

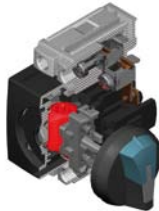
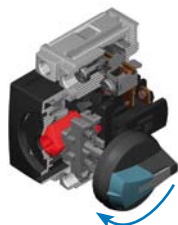

Position I

> SIRCO MV

Sliding electrical contacts:

- High dynamic short circuit current withstand,
- High number of operations.



SIRCO 007 A

STANDARDISED ACCESSORIES

> Direct operation

A direct operation to suit all markets.

SIRCO 102 A - 103 A



Rotary handle



Lever operation (toggle)

> External operation

Compact and robust, the rotary handle enables the same switch to be operated either from a front, left or right side.

ACCESS 278 A - 279 A



16 to 80 A



100 to 160 A

> Additional poles

3 additional pole versions are available:

- a switched fourth pole module,
- an unswitched neutral pole,
- a protective earth module (unswitched pole).

SIRCO 072 B



> Auxiliary contacts

The pre-break and signalisation function of these auxiliary contacts enables the anticipation of the switching of the main poles.

SIRCO 076 B



> Terminal shrouds

Single, three and four pole they ensure protection against direct contact.

SIRCO 012 A



NEW ADDITIONAL FEATURES

> Door / Panel mounting kit

For a quick and easy installation.



Overall dimensions reduced



Right or left side mounting



Door mounting

SIRCO 170 A - 167 A - 158 A



Complete protection IP2X

SIRCO 015 A

> Conversion kit

This accessory enables the assembly of two 3 pole switches + additional poles in order to achieve:

- 6 or 8 pole load break switches,
- 3 or 4 pole changeover switches (I - 0 - II) or (I - I+II - II).



SIRCO 062 A - 016 A

SIRCO M and MV

Ten **multipolar** ratings from 16 to 160 A
for LV **industrial and commercial applications**

	SIRCO M 16 to 40 A	SIRCO M 63 to 80 A	SIRCO M 100 and 125 A	SIRCO MV 100 to 160 A
FUNCTIONS				
3/4-pole load break switches	•	•	•	•
6/8-pole load break switches	•	•		
3/4-pole changeover switches (I - 0 - II)	•	•		
3/4-pole changeover switches (I - I+II - II)	•	•		
CHARACTERISTICS				
OPERATION				
Manual	•	•	•	•
Lever (Toggle)	•	•		
DIRECT HANDLE				
Front	•	•	•	•
DOOR INTERLOCKED EXTERNAL HANDLE				
Front	•	•	•	•
Right side	•	•	•	•
Left side	•	•	•	•
BREAKING				
Positive break indication	•	•	•	•
Visible				•
SWITCH BODY				
Modular	•	•	•	•

Compact enclosure

- Polycarbonate housing.
- IP65.
- 2 colourings:
 - grey lid and black handle,
 - yellow lid and red handle.
- 2 enclosure sizes to facilitate the connection :
 - **16 to 40 A case**
(H x L x P : 162 x 66 x 92 mm) pre-drill holes:
2 on the right and 2 on the left side M16, 2 on the top and 2 on the bottom M20/25, 4 on the backside M20,
 - **63 to 100 A**
(H x L x P : 210 x 125,5 x 92 mm) pre-drill holes:
2 on the right and 2 on the left side M16, 2 on the top and 2 on the bottom M25/32, 2 on the backside M25/32.
- Removable neutral and earthing terminals.
- Lid fixed by sealed screws.
- Sectile mounting lugs.

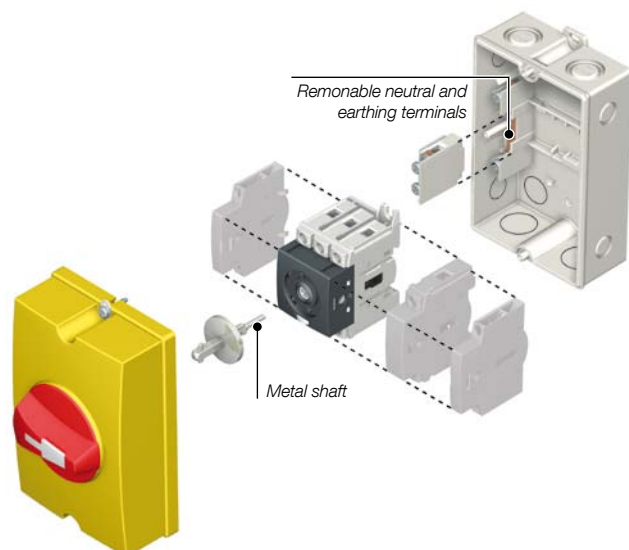

SIRCO MV

The appropriate product for all **enclosed applications**

> Mounting inside an enclosure

- DIN rail mounted



- Back plate mounted



> Voltage tap

Voltage sensing and power supply accessory.



> 3 operating directions



Direct front operation



External right side operation



External front or left side operation

Socomec *worldwide*

IN EUROPE

BELGIUM

SOCOMECH BELGIUM
B - 1190 Brussel
Tel. +32 (0)2 340 02 30 - Fax +32 (0)2 346 28 99
info.scp.be@socomec.com

FRANCE

SOCOMECH
F - 94132 Fontenay-sous-Bois Cedex
Tel. +33 (0)1 45 14 63 30 - Fax +33 (0)1 45 14 63 38
info.scp.fr@socomec.com

GERMANY

SOCOMECH GmbH
D - 76275 Ettlingen
Tel. +49 (0)7243 65 29 2 0 - Fax +49 (0)7243 65 29 2 13
info.scp.de@socomec.com

ITALY

SOCOMECH Elettrotecnica s.r.l.
I - 20098 San Giuliano Milanese (MI)
Tel. +39 02 9849821 - Fax +39 02 98243310
info.scp.it@socomec.com

SPAIN

SOCOMECH ELECTRO, S.L.
E - 08310 Argentona (Barcelona)
Tel. +34 93 741 60 67 - Fax. +34 93 757 49 52
info.scp.es@socomec.com

THE NETHERLANDS

SOCOMECH B.V.
NL - 3991 CD Houten
Tel. +31 (0)30 760 0901 - Fax +31 (0)30 637 2166
info.scp.nl@socomec.com

THE UNITED KINGDOM

SOCOMECH Ltd
Hitchin Hertfordshire SG4 0TY
Tel. +44 (0)1462 440033 - Fax +44 (0)1462 431143
info.scp.uk@socomec.com

IN ASIA

NORTH EAST ASIA

SOCOMECH CHINA
CN - 200030 P.R.C Shanghai - China
Tel. +86 (0)21 5298 9555 - Fax +86 (0)21 6228 3468
info.scp.cn@socomec.com

SOUTH EAST ASIA & PACIFIC

SOCOMECH SWITCHING AND PROTECTION
UBI TECHPARK - 408569 Singapore
Tel. +65 65 07 94 90 - Fax +65 65 47 86 93
info.scp.sg@socomec.com

SOUTH ASIA

SOCOMECH INDIA
122001 Gurgaon, Haryana - India
Tel. +91 124 4562 700 - Fax +91 124 4562 738
info.scp.in@socomec.com

IN MIDDLE EAST

UNITED ARAB EMIRATES

SOCOMECH Middle East
Dubai, U.A.E.
Tel. +971 (0) 4 29 98 441 - Fax +971 (0)4 29 98 449
info.scp.ae@socomec.com

IN NORTH AMERICA

USA, CANADA & MEXICO

SOCOMECH Inc
Cambridge, MA 02142 USA
Tel. +1 617 245 0447 - Fax +1 617 245 0437
info.scp.us@socomec.com

HEAD OFFICE

SOCOMECH GROUP

S.A. SOCOMECH capital 11 149 200 €
R.C.S. Strasbourg B 548 500 149
B.P. 60010 - 1, rue de Westhouse
F-67235 Benfeld Cedex - FRANCE

INTERNATIONAL SALES DEPARTMENT

SOCOMECH

1, rue de Westhouse - B.P. 60010
F - 67235 Benfeld Cedex - FRANCE
Tel. +33 (0)3 88 57 41 41 - Fax +33 (0)3 88 74 08 00
info.scp.isd@socomec.com

www.socomec.com

Non contractual document. © 2011, Socomec SA. All rights reserved.



Ref: DOC 68093 - 09/11 - Photo: Martin Bernhart - Réalisation: SOCOMECH Service Communication - Gysis Imprimeur Obernai - To help protect the environment, this document has been printed on PEFC paper (Programmes for the Endorsement of Forest Certification) - COUV 134-C